



THE JOHN MILTON SIXTH FORM @ STOW UP LAND HIGH SCHOOL



“

*A Sixth Form with a  
sense of community*

# Helping you to navigate your future

---

Your Sixth Form years are exciting, and choosing the environment that's right for you is an important step in making the transition from Key Stage 4 to adulthood. Our focus is to help you achieve the results you need - but we go much further. We equip you with important life skills to help you progress to higher education, employment or an apprenticeship. We encourage you to think harder and challenge what you already know. We give you the space to explore ideas and interests, and to develop your creative and critical thinking skills.

You will have the opportunity to take part in volunteering, student-led committees and forums where you'll learn organisational skills, take on more responsibility and play an active part in a community focused Sixth Form.



# State of the Art Building



Our exciting new Sixth Form centre opened in January 2021. The building is at the leading edge in design and comfort that enables you to study in a professional, modern environment.

It houses five bespoke classrooms, an ICT suite, a café/study area and a large performance assembly area as well as an outdoor terrace surrounded by spacious parkland. The Sixth Form centre has been designed to accommodate your independence and we encourage you to make full use of the catering and office facilities to support your studies.

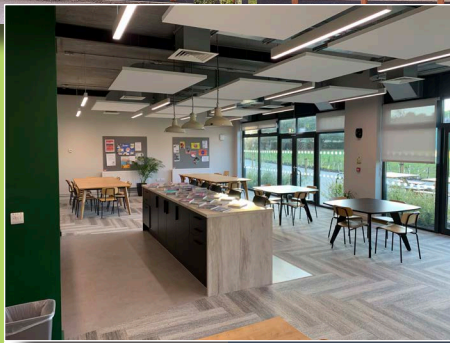

# Elliot Mayes

---

Studying: Mathematics, Product Design and Music Technology

Next Steps: Study Architecture



The transition from GCSE to A Level was completed with ease thanks to staff allowing students to fit into the sixth form environment well. Studying A Levels, we work more independently than at GCSE. However, we still receive support needed to achieve our academic goals, which prepares us for Uni and the wider world. There is also a wide array of extra-curricular activities on offer and students who join from other schools are made to feel welcome, making their time at Stowupland the best it could possibly be.



# Jamie Carlin

Studying: Mathematics, Chemistry and Biology

Next Steps: Study Pharmaceuticals



As a previous student of Debenham High School, I felt concerned about joining a new Sixth Form, however the team at Stowupland Sixth put me at ease right away. Since joining I have been warmly invited into the school environment and am really enjoying my time here. I would recommend Stowupland Sixth form to students from other schools, as I feel a sense of belonging here.



# Curriculum

Our Sixth Form offers a wide range of A-Level and applied Level 3 courses - well supported by a programme of visits, work experience, internships, clubs, societies and other extracurricular activities. These will enable you to devise personalised programmes which suit your individual needs and aspirations. We encourage you to set your sights high because you will be following demanding programmes of study.

Our tutorials and assessment system will help you pursue realistic and challenging targets, review your progress and take full responsibility for your learning. Your tutors will provide you with all the support you need to develop your resilience, confidence and interpersonal skills.



*Excellent teacher-to-student ratios and close work with our Inclusion Team ensure that students can follow personalised programmes and access the individual support that is vital to their success.*







## EXTENDED CURRICULUM

Universities are increasingly looking for the Extended Project Qualification as an additional Level 3 qualification. It provides you with the research and evaluation skills necessary to succeed at university. Those who take the EPQ often receive lower conditional offers when applying to Universities. Even better, it's a chance to shine in a subject and pursue something you are really interested in. Although your work is an independent project, you will get plenty of support and guidance in completing it.

## SUPPORT WITH OXBRIDGE APPLICATIONS

Oxbridge applicants benefit from our established and successful liaison work with St Catharine's College, Cambridge. We have great experience in this area and begin preparing students early in Year 12. Students receive bespoke application mentoring, personal statement support and interview preparation.



# Support

---

## FINANCIAL SUPPORT

We recognise that supporting students financially through post-16 education is difficult for some families. We can offer financial support through the 16-19 Bursary Scheme. This helps students with a range of educational requirements which may include: transport, food, educational books and materials, laptops, course-related trips, UCAS applications and Open Day costs, sport activities, and professional membership fees. If you think you may be entitled to the bursary, please let us know.



## ACADEMIC TUTORS

Life in the Sixth Form offers many new opportunities and demands. At Stowupland, all students have a tutor to guide them and track their progress. Tutors are the first point of contact for parents and students regarding progress, attainment and pastoral care. Your tutor is also a member of the Sixth Form Progress Team which works closely with teaching staff to provide effective and swift intervention should you experience difficulties.



# Volunteering

As a member of the Sixth Form, you will be expected to participate in one of our volunteering schemes. Employers value the skills of communication, initiative, problem solving and resilience, all of which you will be able to develop through volunteering.

Our school mentoring programme is run by our year 12 students, who receive comprehensive training and relish the opportunity to make a difference for our students in Key Stage 3.



*I have learnt the importance of responsibility and the value of building trusting relationships through mentoring. In addition to this, when volunteering at sports day and open evening, I realised the need for teamwork and confidence to ensure the tasks provided were completed to the standard needed.*



*I have learnt many things from volunteering including seeing things from other people's perspective and how I can influence people's decisions in regards to school and how they act during it. I have enjoyed meeting my mentees and getting to know them as people and helping them throughout the year with all of them improving.*





# How to apply

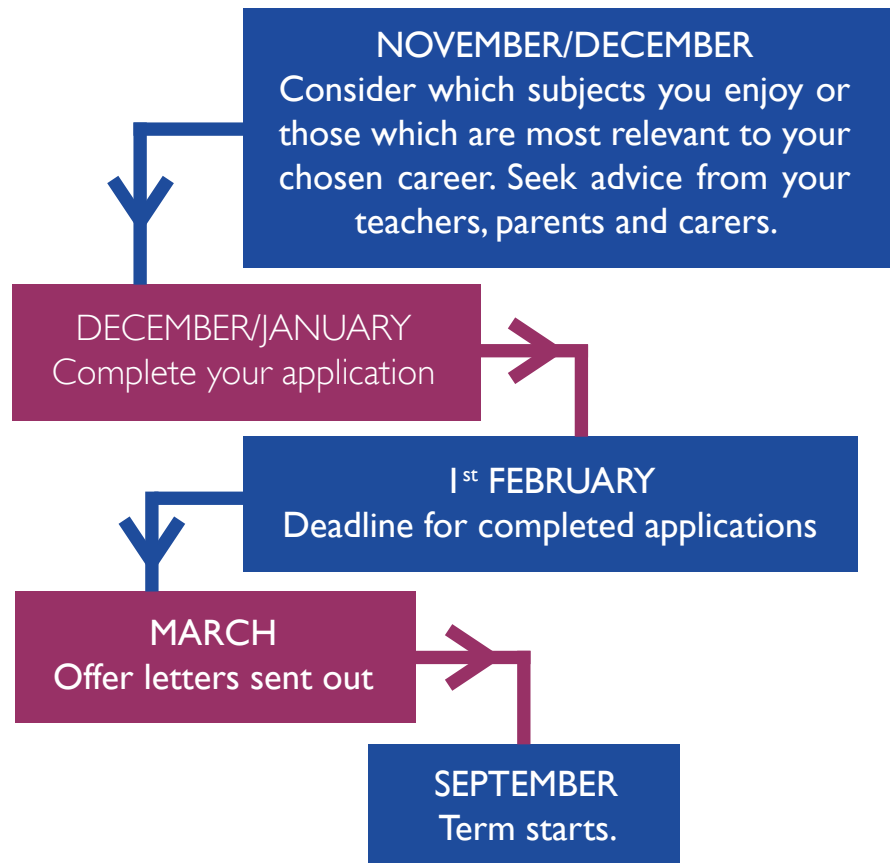

WELCOME TO YEAR 12

# Entry Requirements

---

APPLIED BUSINESS STUDIES  
Grade 4 in English

---

APPLIED PSYCHOLOGY  
Grade 4 in English

---

APPLIED SCIENCE  
Grade 4 in all sciences

---

ART AND DESIGN  
Grade 5 in Art

---

BIOLOGY  
Grade 5 in Biology

---

CATERING  
Grade 5 in Food Technology or grade 5 in English

---

CRIMINOLOGY  
Grade 5 in English

---

CHEMISTRY  
Grade 5 in Chemistry

---

COMPUTER SCIENCE  
Grade 5 in Computer Science or ICT or Mathematics

---

CORE MATHEMATICS  
Grade 5 in Mathematics

---

DANCE  
Grade 5 in Dance if taken, otherwise interview required

---



## DRAMA

Grade 5 in Drama

## ENGLISH LANGUAGE

Grade 5 in English Language

## ENGLISH LITERATURE

Grade 5 in English Literature

## EXTENDED PROJECT QUALIFICATION

Grade 5 in English

## FRENCH

Grade 5 in French

## FURTHER MATHEMATICS

Grade 7 in Mathematics

## GEOGRAPHY

Grade 5 in Geography

## GERMAN

Grade 5 in German

## HEALTH AND SOCIAL CARE

Merit in Level 2 Health and Social Care or Grade 4 in English

## HISTORY

Grade 5 in History

## INFORMATION TECHNOLOGY

Grade 5 in Information Technology or Mathematics

## MATHEMATICS

Grade 5 in Mathematics (Higher Paper to be sat)

## MEDIA STUDIES

Grade 5 in English

## MUSIC TECHNOLOGY

Merit in Level 2 Music or ability to play an instrument and interview

## PHILOSOPHY

Grade 5 in Religious Studies or History or English

## PHYSICS

Grade 5 in Physics

## POLITICS

Grade 5 in English or History or Religious Studies

## PRODUCT DESIGN

Grade 5 in Design Technology

## SPORTS SCIENCE

Merit in Level 2 Sport or Grade 4 in PE or Grade 4 in Biology

## SOCIOLOGY

Grade 5 in English Language or a Humanities Subject



JOHN MILTON SIXTH FORM  
STOWUPLAND HIGH SCHOOL  
Church Road  
Stowupland  
Suffolk  
IP14 4BQ

01449 674827

sixthform@  
stowuplandhighschool.co.uk



**JOHN MILTON  
ACADEMY TRUST**

Ambition • Aspiration • Excellence

